



Total Food-Service Solutions

Modular Cooking - Amicus 600

Electric Frit Warmer

NEFW 4-60 AM

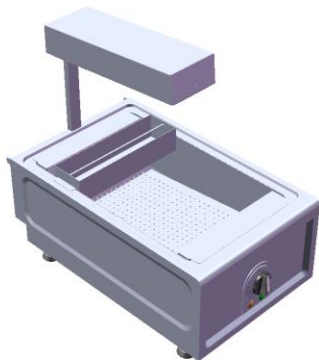

*Due to routine technical improvement, the photograph shown may not represent the latest design of the products.

AVAILABLE MODEL

1. NEFW 4-60 AM

DESCRIPTION

Electric Frit Warmer consists of infrared heating element with 1 kW power rate, equipped with removable salting pan.

Unit to be installed as a table top, on open cabinet or similar elements, cantilever, or cooking suite block configuration. Featuring rear seamless fitting to connect with other Amicus family.

ITEM# : _____

MODEL# : _____

NAME : _____

SN : _____

MAIN FEATURE

- Infrared heating element 1 kW keeps the meal warm until ready to be plated and served.
- Fully welded 1 GN well basin for optimum cleaning operation.
- Salting pan with close distance holes for better dripping as included accessories.
- Can be, ideally, positioned next to a fryer for oil dripping and keeping warm workflow.

CONSTRUCTION

- All exterior panels in 304 type of Stainless Steel
- Orbital top surface anti-scratch finishing.
- Top with 1.2 mm surface.
- Side with 1.2mm pressed surface.
- Front with 0.8 mm pressed surface.
- Adjustable ± 30 mm leg.

INCLUDED ACCESSORIES

- Salting Pan
- Clip Plate for Joining
- Power cable

OPTIONAL ACCESSORIES

: _____

The company reserves the right to make modifications to the products without prior notice.
All information correct at time of printing.
2019.08.26



Modular Cooking - Amicus 600
Electric Frit Warmer
NEFW 4-60 AM

FRONT

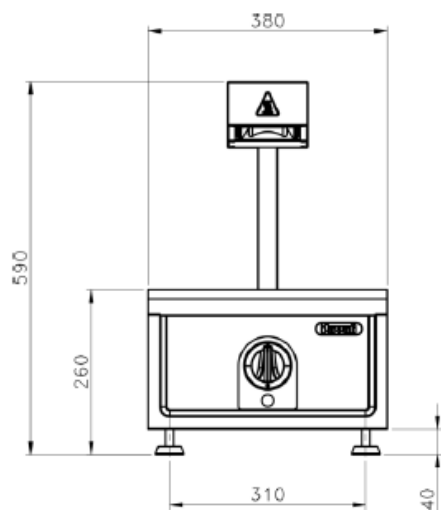

TOP

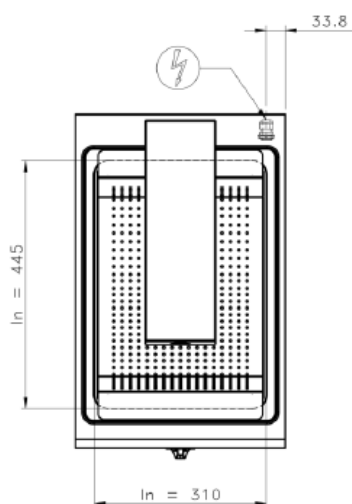

SIDE

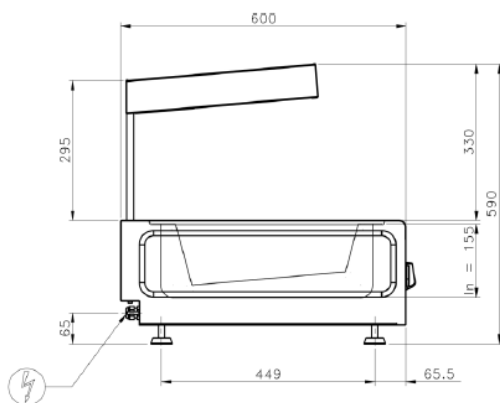

* Overall Dimension in mm

ELECTRIC

Electrical rating (kW)	:	1
Element rating (kW)	:	1
Electrical supply voltage	:	230V 1N
Required electrical supply (amps):	:	5
Power cable	:	
~ Cable type	:	H07RN-F
~ Cable dimension	:	3 x 1.5 mm ²
Electrical current split (amps)	:	L1: 5

KEY INFORMATION

Unit dimension (WxDxH)	:	380x600x260/590 mm
Cooking surface (WxD)	:	310x445x155 mm
Direct heat emission	:	0.35 kW
Net weight	:	17 kg

PACKING DETAILS

Shipping width	:	450 mm
Shipping depth	:	740 mm
Shipping height	:	650 mm
Shipping volume	:	0.216 m ³
Gross weight	:	21 kg